



TOWN OF MAYNARD
Office of Municipal Services
MUNICIPAL BUILDING
195 Main Street
Maynard, MA 01754
Tel: 978-897-1302 Fax: 978-897-8489
www.townofmaynard-ma.gov



Distribution Memo - Approved Plan

TO: Planning Board
Town Administrator / BOS
Department of Public Works/Town Engineer
Chief of the Fire Department
Chief of the Police Department
Building Commissioner
Conservation Commission
Town Clerk
Assessor's Office
Board of Health

FROM: Bill Nemser, Planning Director

DATE: April 4, 2022

SUBJECT: Approved Plan for 2-15 Digital Way (Maynard Crossing) (Petition Number: PB 22-01).

Attached is the plan and decision as approved by the Planning Board at the March 8, 2022 meeting. The plan separates Building R3 into two separate buildings denoted as R3A and R3B. The buildings are in the same general location as the approved R3 building. The R3 building was to be 55,922 SF, and the combined footprint of the two proposed buildings is 46,530 SF which is a decrease of 9,392 SF.
If you have any questions, please contact me at (978) 897-1302.

Thank you for your assistance.

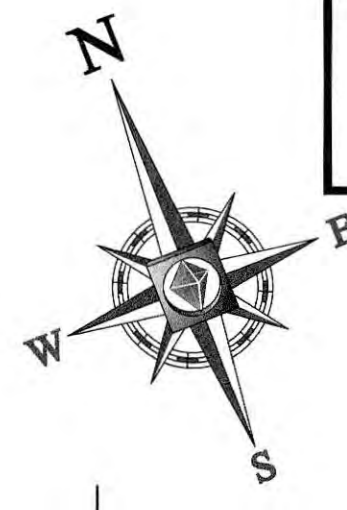

CONTRACTOR SHALL INSTALL ADA RAMP SUCH THAT BOTTOM OF RAMP LANDINGS PROVIDE POSITIVE DRAINAGE AND NOT LOW POINTS SUSCEPTIBLE TO PONDING

GENERAL CONTRACTOR TO ENSURE ALL SIDEWALKS ARE ADA/AAB COMPLIANT WITH 2% MAXIMUM CROSS SLOPES AND 5% MAXIMUM RUNNING SLOPES. CONTRACTOR SHALL ALSO ENSURE ALL RAMP ARE ADA/AAB COMPLIANT IN ACCORDANCE WITH RAMP DETAILS ON CONSTRUCTION DETAIL SHEETS. IF MORE INFORMATION IS NEEDED IN CERTAIN AREAS, CONTRACTOR SHALL SUBMIT AN RFI FOR CLARIFICATION.

FOR PIPE WITHIN 10 FT. OF BUILDING, PIPE MATERIAL SHALL COMPLY WITH APPLICABLE BUILDING AND PLUMBING CODES. CONTRACTOR TO VERIFY WITH LOCAL OFFICIALS.

REFER TO ARCH. PLANS FOR DETAIL OF BUILDING SURROUND INCLUDING SIDEWALKS AND ADA RAMP. COORDINATE CONNECTION OF ADA RAMP TO ACCESSIBLE SPACES AND MAINTAIN 2% MAXIMUM SLOPE IN ALL DIRECTIONS IN ACCESSIBLE PARKING SPACE AND ACCESS AISLE AREAS. REFER TO ADA NOTES ON SHEET 2.

THIS PLAN TO BE UTILIZED FOR SITE GRADING PURPOSES ONLY

REFER TO GENERAL NOTES SHEET FOR GRADING & UTILITY NOTES

REFER TO SHEET 16 FOR STORM DRAINAGE TABLE

TOWN OF MAYNARD PLANNING BOARD APPROVAL

SIGNATURE	DATE
SIGNATURE	DATE
SIGNATURE	DATE
SIGNATURE	DATE
SIGNATURE	DATE

Approved plans - see cover sheet for Planning Board signatures.

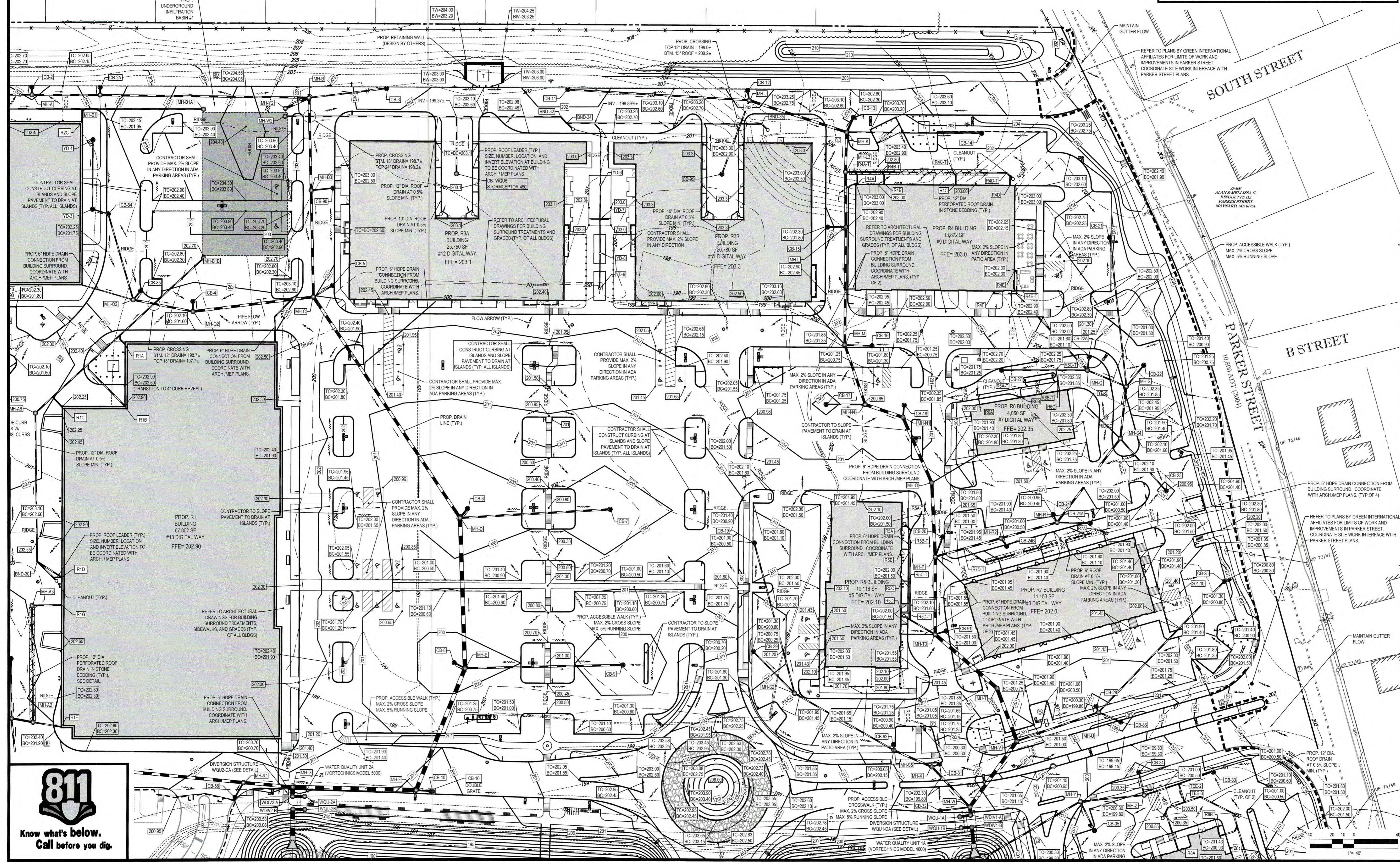

REV	DATE	COMMENT	BY
108	07/25/19	REVISED PER TOWN COMMENTS	CMC
13	10/04/19	REVISED R4-R8 PAD	BPB
13A	11/12/19	REVISED MARKET BASKET	BPB
13B	11/13/19	REVISED R4-R8 PAD	BPB
13C	11/25/19	REVISED R9 PAD	BPB
13D	01/09/20	REVISED R8 PAD	BPB
15	01/16/20	REVISED R4-R7 PAD	BPB
16	01/31/20	REVISED R5 & R8 PAD	BPB
17	04/06/20	REVISED R5 & R7 PAD	CFD
18	04/23/20	R4 - R7 CONSTRUCTION REVS	CFD
19	05/28/20	REVISION TO R8 BUILDING	KLW
20	05/07/21	R10 COMPACTOR	CSE
21	08/09/21	REVISED FOR PLANNING BOARD ENDORSEMENT	EGP
22	12/30/21	REVISION TO R3 BUILDING	EGP
23	02/07/22	R3 REVISION PER TOWN COMMENTS	EGP
24	02/21/22	REVISED R3 PER TOWN COMMENTS	EGP

PRELIMINARY

PROJECT NO.: W161189
DRAWN BY: AMPC/D
CHECKED BY: NEAM/JK
DATE: 01/25/2017
SCALE: AS NOTED
CAD ID: W161189SS24

SITE DEVELOPMENT PLANS
FOR
CAPITAL GROUP
MAYNARD CROSSING
LOCATION OF SITE
MAP #25 & LOTS #152 & 152-1
129 PARKER STREET (ROUTE 27)
TOWN OF MAYNARD
MIDDLESEX COUNTY
MASSACHUSETTS

BOHLER ENGINEERING
352 TURNPIKE ROAD
SOUTH BOROUGH, MA 01772
Phone: (508) 480-9900
Fax: (508) 480-9080
www.BohlerEngineering.com

J.A. KUCHAR
Professional Engineer
No. 10000
MASSACHUSETTS
LICENSED PROFESSIONAL ENGINEER
No. 10000
MASSACHUSETTS

SHEET TITLE:
GRADING & DRAINAGE PLAN "B"
SHEET NUMBER:
13
OF 37
REV 24 - 02/21/2022

NOTES:
PIPE LENGTHS ARE MEASURED CENTER TO CENTER
PIPE MATERIAL IS TO BE HOPE UNLESS SPECIFIED OTHERWISE. REFER TO GENERAL NOTES ON SHEET 2 FOR MORE INFORMATION
* DENOTES DRAINAGE STRUCTURES ASSOCIATED WITH THE LECESSE AND HAWTHORNE DEVELOPMENTS THAT ARE NOT INCLUDED WITH THE CURRENT CONTRACT.

WQU-1A/B IS A VORTECHNICS MODEL 4000
WQU-2A/B IS A VORTECHNICS MODEL 5000
CB30 IS A DOUBLE GRATE CATCH BASIN
WDV1-A/B IS THE DIVERSION STRUCTURE FOR WQU-1A
WDV2-A/B IS THE DIVERSION STRUCTURE FOR WQU-2A
**REFER TO DETAIL SHEET 30 FOR MORE INFORMATION

- (1) STRUCTURE WAS FIELD ADJUSTED BY CONTRACTOR
(2) REVISED PER CONSTRUCTION SKI2
(3) REVISED PER CONSTRUCTION SKI3
(4) ROOF LEADER CONNECTION TO BE CORED BY CONTRACTOR AFTER STRUCTURE INSTALLED. COORDINATE WITH MASTER DEVELOPER

TOWN OF MAYNARD PLANNING BOARD APPROVAL

SIGNATURE	DATE
SIGNATURE	DATE
SIGNATURE	DATE
SIGNATURE	DATE
SIGNATURE	DATE

Approved plans - see cover sheet for
Planning Board signatures.

STR	RIM GRT	INV. IN	INV. OUT	OUT PIPE SIZE	PIPE LENGTH	OUT PIPE SLOPE
YD-6	202.15	200.20(YD-7)	200.20(ROOF)	8"	58'	0.50%
YD-7	202.15	200.35(YD-8)	200.35(YD-6)	8"	31'	0.50%
YD-8	202.31	200.49(YD-9)	200.49(YD-7)	8"	30'	0.50%
YD-9	202.31	200.65(YD-8)	200.65(YD-8)	8"	32'	0.50%
CB-WQU3	202.40		199.60(ROOF)	12"	51'	0.50%
CB-95	202.60		197.63(MH-J)	12"	65'	2.00%

STR	RIM GRT	INV. IN	INV. OUT	OUT PIPE SIZE	PIPE LENGTH	OUT PIPE SLOPE
B4*		194.50(CB-71*)	8"	4'	0.00%	
B5*		194.50(CB-88*)	8"	9'	0.00%	
B6*		194.50(CB-74*)	8"	4'	0.00%	
B9*		194.50(CB-78*)	8"	11'	0.00%	
B10*		194.50(CB-79*)	8"	9'	0.00%	
B11A*		194.50(CB-80*)	8"	7'	0.00%	
B11B*		194.50(BND-6*)	8"	3'	0.00%	
B12A		195.50(CB-82)	8"	23'	0.00%	
B12B		195.50(CB-83)	8"	9'	0.00%	
BND-1*	194.50(CB-73*)	194.50(BND-2*)	8"	3'	0.00%	
BND-2*	194.50(BND-1*)	194.50(TEE-1*)	8"	51'	0.00%	
BND-3*	193.50(BND-4*)	193.50(MH-B7*)	8"	17'	0.00%	
BND-4*	193.50(CB-76*)	193.50(BND-3*)	8"	11'	0.00%	
BND-5*	194.50(BND-6*)	194.50(CB-81*)	8"	18'	0.00%	
BND-6*	194.50(B11B*)	194.50(BND-5*)	8"	3'	0.00%	
BND-7*	195.76(R3A*)	195.76(BND-8*)	12"	12'	0.51%	
BND-8*	195.70(BND-7*)	195.70(BND-9*)	12"	235'	0.00%	
BND-9*	195.70(BND-8*)	195.70(BND-10*)	12"	14'	0.00%	
BND-10*	195.70(BND-9*)	195.70(MH-L3A*)	12"	73'	0.00%	
BND-11*	195.70(BND-12*)	195.70(MH-L3A*)	12"	49'	0.00%	
BND-12*	195.70(BND-13*)	195.70(BND-11*)	12"	21'	0.00%	
BND-13*	195.70(BND-14*)	195.70(BND-12*)	12"	71'	0.00%	
BND-14*	195.81(MH-L2*)	195.81(BND-13*)	12"	21'	0.52%	
BND-15*	196.68(BND-15*)	196.68(MH-L2*)	12"	143'	0.49%	
BND-16*	196.71(R3C*)	196.71(BND-15*)	12"	6'	0.49%	
BND-17*	196.05(R1H*)	196.05(BND-18*)	12"	5'	1.11%	
BND-18*	196.00(BND-17*)	196.00(MH-W3*)	12"	142'	0.00%	
BND-19*	196.53(R1E*)	196.53(BND-20*)	12"	3'	0.91%	
BND-20*	196.50(BND-19*)	196.50(MH-L1A*)	12"	134'	0.00%	
BND-21*	196.58(R1C*)	196.58(BND-22*)	8"	9'	0.93%	
BND-22*	196.50(BND-21*)	196.50(MH-M1A*)	12"	52'	0.00%	
BND-23*	196.50(BND-24*)	196.50(MH-M1A*)	12"	29'	0.00%	
BND-24*	196.60(R1B*)	196.60(BND-23*)	8"	10'	1.03%	
BND-25*	196.60(R1A*)	196.60(BND-26*)	8"	10'	1.03%	
BND-26*	196.50(BND-25*)	196.50(MH-N1A*)	12"	33'	0.00%	
BND-27*	196.50(BND-28*)	196.50(MH-N1A*)	12"	46'	0.00%	
BND-28*	196.58(R1L*)	196.58(BND-27*)	8"	9'	0.97%	
BND-29	197.00(R6B-T)	197.00(MH-S)	12"	16'	0.00%	
BND-30	200.24(R1D)	200.24(MH-A6)	12"	135'	0.50%	
BND-31	200.32(R2A)	200.32(MH-B1A)	12"	455'	0.40%	
BND-32	199.75(BND-34)	199.75(MH-W2)	18"	250'	0.40%	
BND-34	199.79(BND-35)	199.79(BND-32)	18"	8'	0.51%	
BND-35	200.50(BND-34)	200.50(BND-34)	15'	178'	0.40%	
CB-1	201.60	199.10(MH-A4)	12"	123'	0.50%	
CB-1A	201.60	198.63(MH-A4)	12"	7'	1.96%	
CB-2	201.70	198.24(MH-A)	12"	7'	1.96%	
CB-2A	201.50	198.50(MH-B1)	12"	7'	1.96%	
CB-3	201.65	197.05(MH-B)	12"	71'	0.99%	
CB-4	201.14	197.00(MH-C2)	12"	9'	1.09%	
CB-5	201.80	198.00(MH-C)	12"	20'	1.08%	
CB-6	199.00	195.50(MH-D)	18"	11'	2.00%	
CB-7	199.15	195.38(MH-D)	18"	13'	0.50%	
CB-8	199.00	195.50(MH-E)	12"	11'	2.00%	
CB-9	199.00	195.22(MH-E)	18"	144'	0.50%	
CB-10	199.50	195.50(MH-F)	12"	14'	0.98%	
CB-11	201.20	197.16(MH-J)	15'	165'	0.50%	

STR	RIM GRT	INV. IN	INV. OUT	OUT PIPE SIZE	PIPE LENGTH	OUT PIPE SLOPE
R6A		197.95(R6A-T)	8"	47'	0.50%	
R6B		197.95(R6A-T)	6"	10'	2.30%	
R6C	197.72(R6A/R6B)	197.72(R6B-T)	6"	33'	0.50%	
R6A-T		197.95(R6A-T)	6"	10'	4.00%	
R6B-T	197.55(R6C/R6A-T)	197.55(R6C-T)	8"	9'	0.50%	
R6C-T		197.50(R6B-T)				

STR	RIM GRT	INV. IN	INV. OUT	OUT PIPE SIZE	PIPE LENGTH	OUT PIPE SLOPE
CB-12	201.80	198.00(MH-J)	12"	9'	2.01%	
CB-13	201.80	197.50(MH-K)	18"	15'	2.00%	
CB-14	201.55	197.00(MH-K)	12"	123'	1.00%	
CB-15	201.80	196.17(MH-L)	12"	16'	1.00%	
CB-16	201.00	197.00(MH-M)	12"	25'	2.00%	
CB-17	199.80	195.80(MH-N4)	12"	36'	2.00%	
CB-18	200.30	196.63(MH-N1)	12"	8'	1.00%	
CB-19	200.50	197.10(MH-S2)	12"	142'	0.50%	
CB-20	201.00	197.10(MH-P)	12"	19'	1.05%	
CB-21	201.25	197.68(MH-S)	12"	136'	0.50%	
CB-22	200.50	197.25(MH-S)	12"	25'	1.00%	
CB-22A	200.95	197.35(MH-Q)	12"	12'	1.25%	
CB-22B	200.40	197.15(MH-S3)	12"	14'	0.49%	
CB-23	200.95	197.38(MH-S4)	12"	63'	1.03%	
CB-24	200.45	196.60(MH-R)	12"	7'	1.90%	
CB-25	200.30	195.50(MH-U)	12"	164'	0.51%	
CB-26	199.20	194.99(MH-T3)	12"	24'	2.02%	
CB-27	201.25	198.00(MH-Q)	12"	78'	1.03%	
CB-28	199.80	195.95(MH-U)	12"	7'	2.01%	
CB-29	200.25	196.65(MH-S2)	12"	54'	0.50%	
CB-30	202.05	200.50(MH-X)	12"	20'	26.40%	
CB-31	199.50	195.44(MH-X)	12"	8'	2.00%	
CB-32	199.50	195.50(MH-W)	12"	27'	1.00%	
CB-33	200.00	194.86(TEE-2)	12"	33'	0.51%	
CB-34	198.75	194.75(MH-Z)	12"	21'	1.03%	
CB-35	199.60	195.80(MH-Y)	12"	16'	1.99%	
CB-36	199.10	195.00(MH-A1)	12"	156'	1.00%	
CB-37	199.05	195.70(MH-A1)	12"	15'	1.98%	
CB-38	199.50	196.50(MH-C1)	12"	33'	2.00%	
CB-39	199.50	196.50(MH-C1)	12"	8'	2.11%	
CB-40	200.75 (4)	197.75(MH-C1)	12"	234'	1.00%	
CB-41	199.70	195.00(MH-B14B)	15"	18'	0.00%	
CB-42	199.70	195.00(MH-B15)	15"	9'	0.00%	
CB-43	201.25	197.00(MH-H)	15"	25'	3.98%	
CB-45	201.55	197.12(MH-K1)	12"	10'	0.98%	
CB-46	201.85	198.35(MH-K1)	12"	131'	1.02%	
CB-48	199.70	195.00(MH-F1)	15"	8'	0.00%	
CB-49	199.70	195.65(MH-G1)	15"	6'	2.51%	
CB-50	199.85	196.43(MH-G1)	15"	70'	0.50%	
CB-51*	199.00	196.03(MH-Q1*)	15"	141'	0.50%	
CB-52*	199.00	195.43(MH-Q1*)	15"	7'	2.08%	
CB-53*	199.00	195.04(MH-O1*)	15"	77'	1.04%	
CB-54*	199.00	194.25(MH-N1*)	12"	11'	1.03%	
CB-55*	199.00	194.50(MH-M1A*)	15"	10'	2.05%	
CB-56*	199.40	194.50(MH-L1A*)	14"	90'	1.26%	
CB-57*	199.10	195.00(MH-S1*)	12"	81'	1.00%	
CB-58	200.05	196.00(MH-R1)	12"	15'	0.99%	
CB-59*	199.00	195.10(MH-T1*)	12"	96'	1.02%	
CB-60*	199.00	194.38(MH-M1*)	12"	7'	0.99%	
CB-61*	199.00	194.94(MH-V1*)	12"	10'	1.06%	
CB-62*	199.10	195.31(MH-W1*)	12"	13'	0.99%	
CB-63*	199.00	195.16(MH-W1*)	15"	129'	0.50%	
CB-64*	199.50	195.71(MH-Z2)	12"	103'	0.50%	
CB-65	199.35	196.83(FES-12A)	8"	55'	0.00%	
CB-66 (1)	199.35	196.83(FES-12B)	8"	55'	0.00%	
CB-68	198.91	196.83(FES-11)	8"	16'	0.00%	

ADDITIONAL DRAINAGE TABLE						
STR.	RIM/ GRT	INV. IN	INV. OUT	OUT. PIPE SIZE	PIPE LENGTH	OUT. PIPE SLOPE
MH-B14C	199.95	195.00(CB-44)				
CB-44	199.70		186.33(MH-E1A) 195.00(CB-44)MH-B16C	12" 12"	8' 18'	1.64% 0.00%
CB-43A	201.50		194.50(MH-B16)	12" 12"	23'	0.00%
MH-B16	202.05	194.50(CB-43A)				
CB-45A	201.75		195.50(BASIN#16A) 195.00(CB-45A)MH-B16C	12" 12"	3' 3'	0.00% 0.00%
MH-E1A	199.80	195.00(MH-B1) 195.00(CB-44)	195.00(MH-E1)	18" 49'	49'	0.51%
MH-F1	202.28	195.47(MH-J1) 197.75(CB-45A)	195.47(MH-F1)	18" 134'	134'	0.50%
--	--	--	--	--	--	--
R9A			196.90(R9B)	8" 53'	53'	1.00%
R9B		196.37(R9A)	195.70(MH-U)	12" 58'	58'	1.00%
CB93	198.85		195.80(MH-R10B)	12" 11'	11'	0.94%
CB94	199.50		195.50(MH-Z7)	12" 61'	61'	0.98%
MH-Z7	200.98	195.90(CB-94)	195.80(MH-R10B)	15" 104'	104'	0.96%
MH-R10C	202.20	197.00(MH-R10D)	196.90(MH-R10G)	15" 88'	88'	0.51%
MH-R10D	202.60	197.00(R10C)	197.00(MH-R10C)	15" 150'	150'	0.00%
MH-R10E	202.20	197.00(MH-R10E)				
MH-R10E	202.20	197.00(R10B)	197.00(MH-R10D)	15" 157'	157'	0.00%
MH-R10G	202.42	196.45(MH-R10C)	195.35(MH-Z2)	15" 15'	15'	0.86%
MH-WQU4	201.40	193.33(MH-WQU3)	193.33(MH-Z3)	15" 27'	27'	1.21%

DRAINAGE TABLE							
	STR.	RIM GRT	INV. IN	INV. OUT	OUT. PIPE SIZE	PIPE LENGTH	OUT. PIPE SLOPE
C3	CB-69	200.50		196.60(MH-A5)	18"	42'	1.50%
	CB-69A	201.00		197.50(MH-A5)	12"	54'	1.00%
	CB-70*	198.45		195.95(MH-B2*) 194.50(MH-B6B)	12"	6' 31"	0.00% 0.08%
	CB-71*	198.45	194.50(B4*)	195.95(MH-C2*)	12"	8'	1.01%
	CB-72*	198.45	194.50(TEE-1*)	195.95(MH-D2*)	12"	7'	1.99%
	CB-73*	198.60		195.95(MH-D2*) 194.50(MH-D1*)	12"	56' 4"	2.49% 0.00%
	CB-74*	198.00	194.50(B6*)	195.50(MH-Z1*)	12"	10'	0.98%
	CB-75*	198.00		195.50(MH-Y1*) 194.50(MH-B6*)	12"	11' 5"	1.00% 0.00%
	CB-76*	197.00		194.50(MH-G2*) 193.50(MH-B8)	12"	14' 8"	1.00% 0.00%
	CB-77*	198.10		194.50(MH-H2) 193.50(MH-HB)	12"	11' 36"	1.05% 0.00%
	CB-78*	199.10	194.50(B9*)	195.22(MH-H2)	12"	113'	1.00%
	CB-79*	198.20	194.50(B10*)	195.70(MH-F2*)	12"	59'	1.00%
	CB-80*	198.20	194.50(B11A*)	195.70(MH-F2*)	12"	8'	1.08%
C2	CB-81*	198.20	194.50(BND-5*)	195.70(MH-E2*)	12"	9'	1.05%
	CB-82	200.75	195.50(B12A)	198.25(MH-N2)	12"	13'	2.02%
	CB-83	200.55	195.50(B12B)	198.25(MH-N3)	12"	14'	0.98%
	CB-84	201.00	197.20(YD-3)	196.69(MH-CQ)	12"	81'	0.51%
	CB-85	201.00		196.89(MH-CQ)	12"	10'	1.06%
	CB-86	198.75		194.93(MH-J)	12"	22'	1.23%
	CB-87*	198.60		195.50(MH-V2)	12"	12'	1.00%
	CB-88*	198.80	194.50(B5*)	196.30(MH-HR2*)	12"	6'	0.95%
	CB-89	200.50		197.50(FE5-9)	12"	149'	0.45%
	CB-90	202.24		198.00(MH-E3)	12"	20'	1.00%
	CB-91	201.00		197.00(MH-T3)	12"	10'	2.00%
	CB-92	200.15		196.10(MH-S5)	12"	5'	2.00%
	FES	FES-1		191.70(WDV2-8)			
FES-2			192.00(WDV1-B)				
FES-3			192.91(MH-V)				
FES-4			192.40(MH-C1)				
FES-5			189.51(MH-S1*)				
FES-6			191.34(MH-L1*)				
FES-7				198.50(MH-H)	18"	105'	2.50%
FES-8			197.00(MH-HR7*)				
FES-9			196.63(CB-89)				
FES-10			193.07(MH-A1)				
FES-11			196.83(CB-68)				
FES-12A			196.83(CB-68)				
FES-12B			196.83(CB-66 (1))				
MH-A	MH-A	201.90	198.11(CB-2) 196.11(MH-A4)	198.11(MH-B1)	18"	62'	0.50%
	MH-A1	199.60	195.40(CB-37) 194.32(CB-36)	194.32(FES-10)	15"	124'	1.00%
	MH-A2	201.65	195.55(MH-A3) 195.55(R1F)	196.55(MH-A5)	18"	20'	1.01%
	MH-A3	202.10	197.60(R1G)	197.60(MH-A2)	12"	106'	0.99%
	MH-A4	201.80	198.49(CB-1) 196.50(CB-1A)	198.49(MH-A)	15"	75'	0.51%
	MH-A5	201.90	196.96(CB-68A) 195.07(CB-69) 195.35(MH-A2)	195.97(MH-H)	18"	36"	0.61%
	MH-A6	201.75	199.57(BND-30)	199.57(MH-B1B)	12"	207'	0.52%
	MH-B	202.85	196.35(CB-3) 195.30(MH-Y2) 196.65(MH-B1)	196.09(MH-B3)	24"	84'	0.50%
	MH-B1	201.65	197.37(CB-2A) 197.80(MH-A)	197.80(MH-B)	18"	190'	0.50%
	MH-B1A	203.60	198.50(BND-31)				
	MH-B1B	202.70	198.50(MH-A6)				
	MH-B2*	205.65	195.69(CB-70*) 193.29(MH-C2*)	193.29(MH-HR2*)	18"	77'	0.50%
	MH-B3	202.65	195.67(MH-B) 197.80(CB-80)	195.67(MH-C)	24"	97'	0.50%
MH-B4A*	198.54		194.50(TEE-1*)	8"	14'	0.00%	
MH-B6B	MH-B6B*	198.50	194.50(CB-70*)				
	MH-B6*	196.10	194.50(CB-75*)				
	MH-B7*	197.40	193.50(BND-3*)				
	MH-B8*	198.10	193.50(CB-77*)				

