

SITE PLAN
SCALE: 1"=40'

NOTES

1. MAINTAIN MINIMUM 12' SEPARATION BETWEEN NEW AND EXISTING FORCE MAIN FROM STA. 3+40 TO STA. 8+25.
2. SEE SHEET E10 FOR ACCESS MANHOLE DETAIL.
3. 12-PAIR DIRECT SERIAL TELEMETRY CABLE TO BE BURIED IN SAME TRENCH WITH NEW FORCE MAIN. MIN. 3" COVER & MAINTAIN 2'-0" SEPARATION W/ FORCE MAIN EXCEPT CABLE TO BE PLACED IN PVC CONDUIT INSTALLED IN FORELASH ZONE ENCLOSURE AT RIVER CROSSING ONLY.
4. REFER TO SPECIFICATIONS FOR ASSABET RIVER CROSSING REQUIREMENTS INCLUDING COVER TYP.

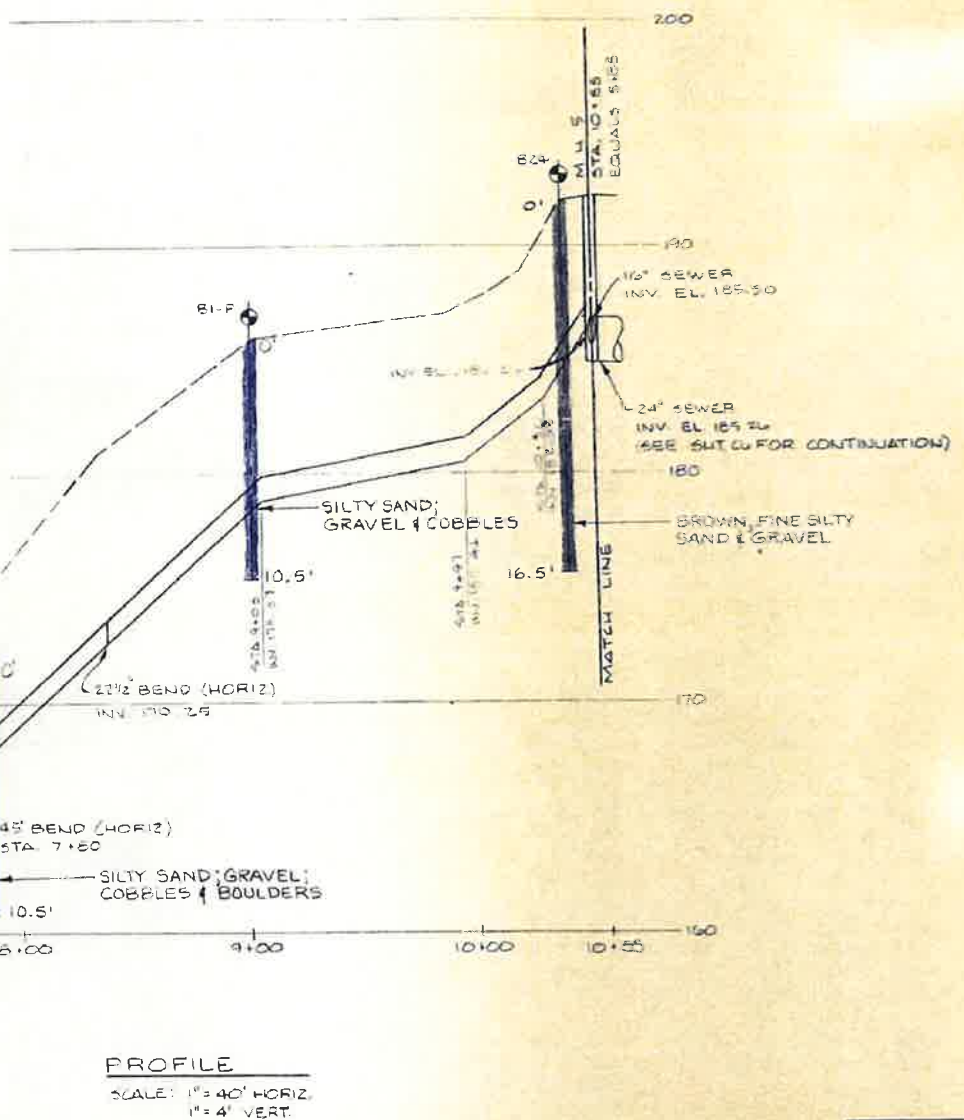
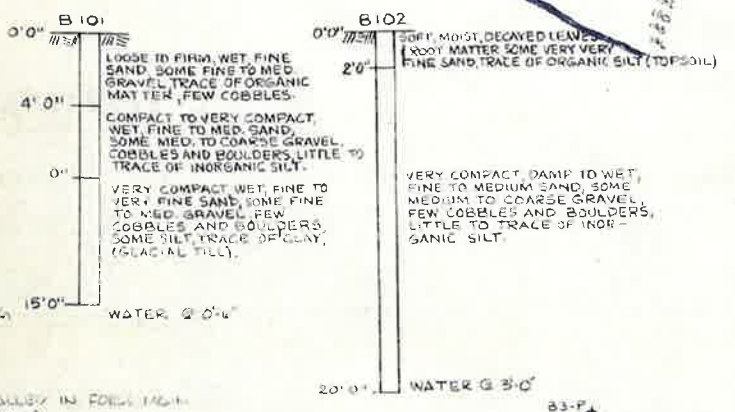

PROFILE
SCALE: 1"=40' HORIZ.
1"=4' VERT.

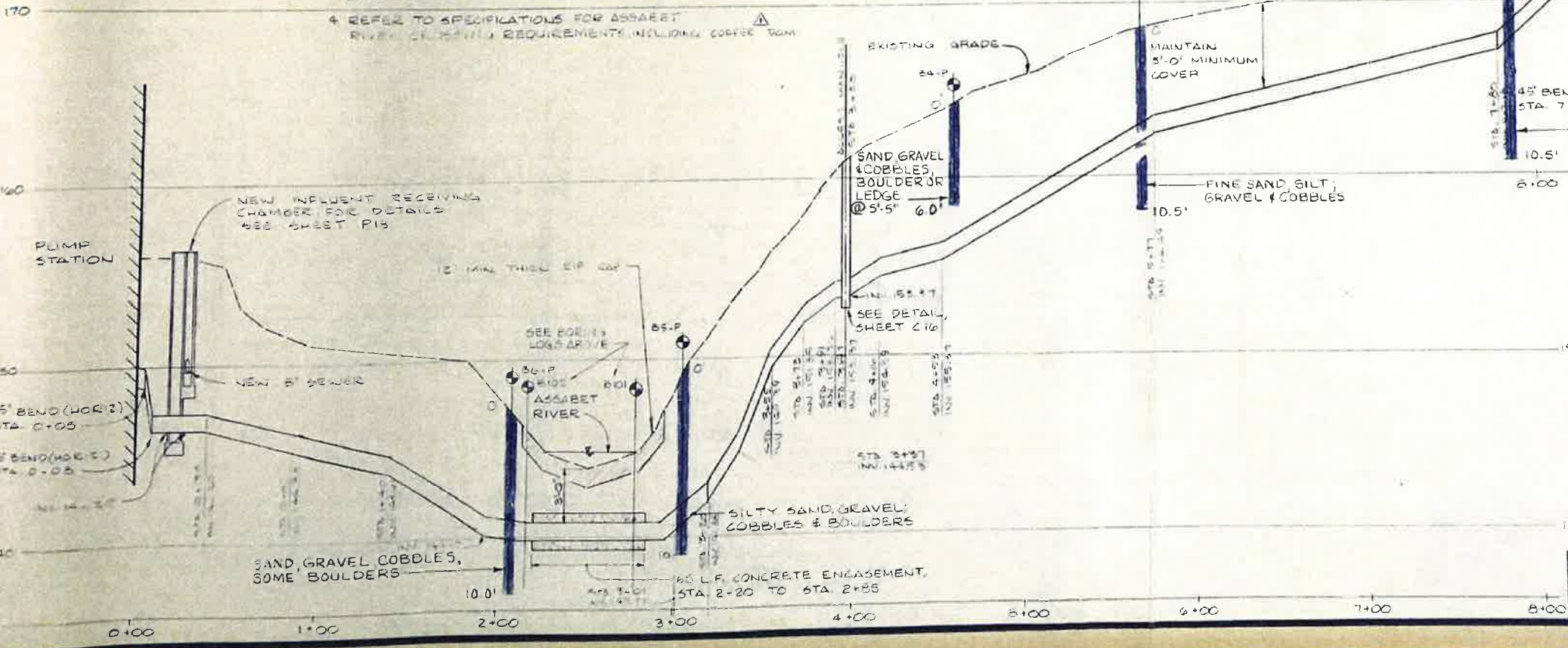

RECORD DRAWINGS

WASTEWATER TREATMENT FACILITIES
MAYNARD, MASSACHUSETTS
FORCE MAIN PLAN AND PROFILE

DH Dufresne-Henry Inc.	Client No.	85-0092	C5
	Proj. Manager	E. RUSHBROOK	
	Proj. Designer	RAH/RKA	
	Drawn By	RLR/PLG	
	Checked By	CAH	
Scale	AS NOTED	Sheet 11 of 102	
Approved	GDC	Date	NOV. 1983

Rev.	Description	By	Date
1	RECORD DRAWINGS	EDL	10-28-83
2	CHANGED NOTES 419	EDL	10-28-83

3057.1